



Welcome to iMap School

"Pupils' personal development, behaviour and welfare are outstanding."

- Ofsted Report 2019



Principals Welcome

Our school is based on a beautiful 84 acre site in Barrow, rural Cheshire. The school specialises in supporting and reengaging pupils with Autism and Autistic traits in education.



Andrea Nelson
Principal

"Thank you for everything you have done for me in 2 years, I have had fun times at this school. Best School Ever."

-Pupil 2019

The school has a number of day pupils, as well as those who attend, and live in our Children's Residential Service. We provide high quality education services for pupils aged 7 – 19, with a high staffing ratio to meet each pupils' need.



Pupils are at the centre of everything we do. Our dedicated staff provides first class support. The education and therapy teams work in partnership, and we pride ourselves on having strong relationships with parents, carers, and stakeholders. This, along with our holistic approach ensures that iMap pupils are empowered to reach their optimum level of achievement.



School is an incredible place for pupils who need to engage again in learning. We have small 1:1 learning spaces, small class sizes, and break-out areas for pupils to reduce levels of anxiety before re-engaging. The school supports all pupils to thrive, learn new skills, grow in confidence and self-esteem, and establish relationships with new peer groups.

Our Ethos

We believe that by
understanding
each pupil it is possible to
help them build their
aspirations
and
empower
them to achieve their goals.



Understand



Empower



Aspire

6 Reasons to choose iMap's School

1. A welcoming, friendly environment where pupils are empowered to develop their social and emotional skills, equipping them for a successful transition to achieve their future goals.
2. A pupil-centered approach where everyone can aspire to excel academically and develop essential life skills.
3. The provision of a broad, balanced, and bespoke curriculum with a variety of accreditation routes promotes life-long learning.
4. A positive and proactive approach to behaviour that supports pupils in learning how to self-regulate anxiety and reduce behaviours of concern.
5. A small bespoke school with a hardworking, knowledgeable, and experienced staff team who understand.
6. Easy access to Chester, Ellesmere Port, Winsford and surrounding areas.



"Pupils' behaviour shows excellent improvement from the time they arrive at the iMap Centre."

- Ofsted Report 2019

2022-2023 School Outcomes

100%

Achievement
of SMSC
targets

80%

Attendance

100%

Destination
Data

98%

Achievement
of Functional
Skills Exams

89%

Learners access
external Work
Experience

100%

Achievement
in Social Skills

90%

Of our learners
progress into
Further Education
and Full Time
Employment

80%

Improvement
in Challenging
Behaviour

90%

Achievement in
Outdoor
Learning

iMap's Growth

Following on from providing an exceptional service for our 11-19 pupils, we are excited to announce that we have expanded our school to cater for Key Stage 2 pupils from September 2019.

The school offers opportunities for young people to aspire to achieve their potential through academic study, personal relationships, and community integration. The creative and imaginative teaching spaces provide a relaxed learning environment that empowers pupils to engage in their education.

The school can offer placements to young people with a variety of needs and diagnoses, including Autism Spectrum Condition, ADHD, and learning difficulties.

"Teachers and support staff have excellent relationships with pupils and manage pupils

The comprehensive bespoke education programme offered to each young person, is

learning effectively...even the most reluctant learners re-engage with learning"
- Ofsted Report

tailored to meet their individual needs, and address in full, all targets

2019

as set out in their Education Health Care Plan.

The school provides full access to the National Curriculum and Equals Curriculum where applicable, modified to meet the needs of all pupils. It is delivered and monitored by highly qualified teaching staff and learning support workers.

Our School

iMap's School is not simply made to be autism friendly, it has been specifically designed for autistic pupils to flourish in. This means that everything from the layout, flooring, paint colour and displays are carefully considered to ensure we are able to provide a fantastic learning environment.

The classroom colours are chosen by students.

We have numerous outdoor spaces which can be used for a variety of different activities.

Our provision for children aged 7-11 and 11+ is separated by the multi-purpose hall.

Transitional spaces such as hallways are painted in a colour which promotes peacefulness and calm behaviour.

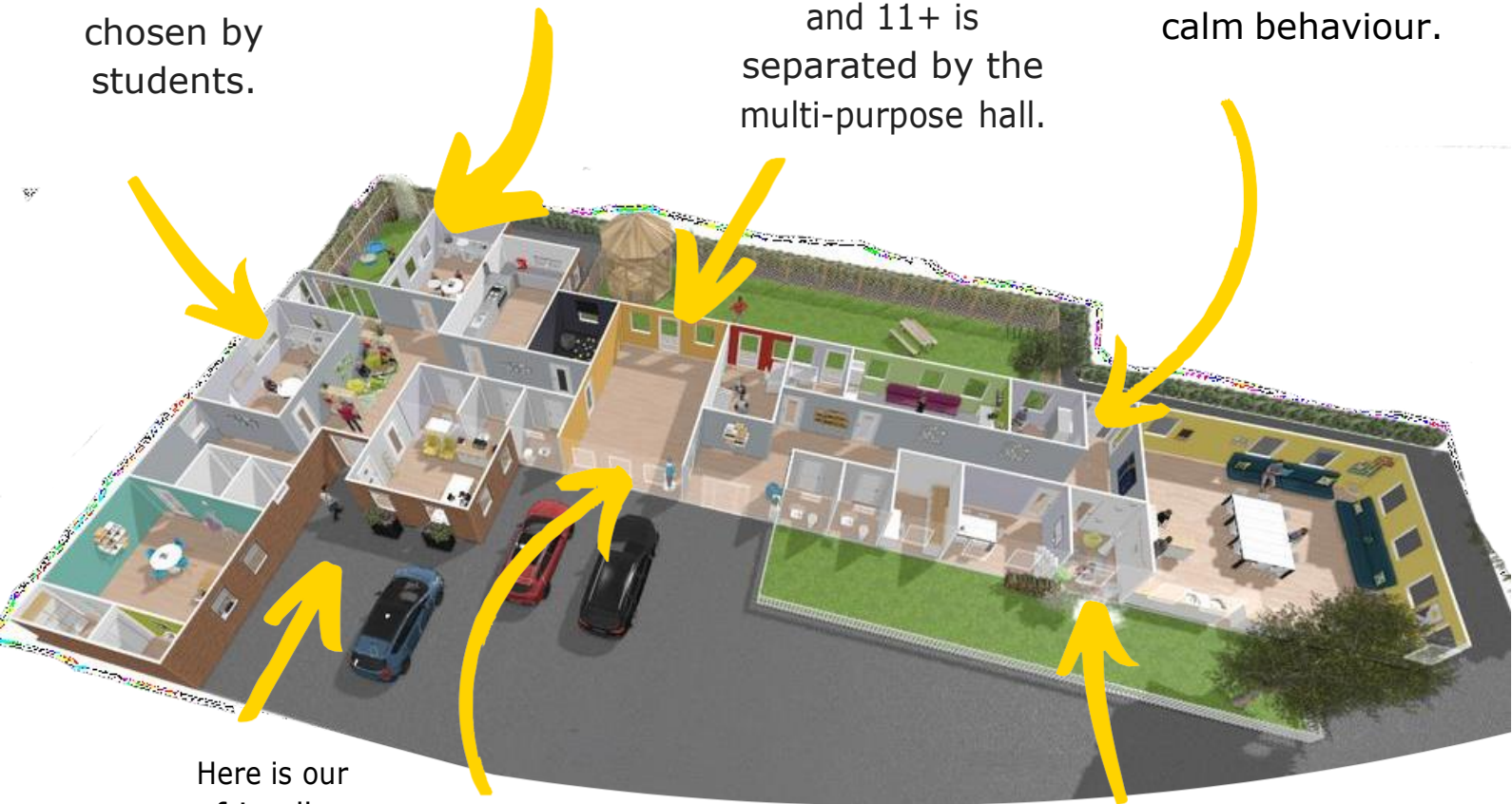

Here is our friendly reception and school admin.

The hall is painted in blue. Perfect for a multipurpose room.

We access sensory areas within our building.

Alternative Provision

This service is for pupils who are struggling to access their current school due to behaviour, or social problems. This programme provides an alternative education provision for pupils in a smaller environment with a high staffing ratio. The aspiration is to re-engage the learner in education, and back into their school, an SEN school, an independent school, or further education placements.

"Pupils enjoy school and attend regularly. Pupils' attendance levels improve significantly once they join the School"

- Ofsted Report 2019

iMap has empowered pupils to achieve their Functional Skills, by providing a 1:1 teaching assistant in a small, quiet environment who is understanding of their Autistic needs, and the anxieties that it can cause during this difficult and stressful time.

iMap has supported pupils to re-engage in learning, within the school and concluded with transitioning the pupils into General Further Education placements.



Pathway For Life

The Pathway for Life curriculum is a bespoke Post 16 package which supports pupils who don't meet the requirements for employment or a residential pathway. This programme empowers the individual to learn skills which will support them in their future life and to aspire to be as independent as they are able.

The programme supports independent living skills, where pupils will follow a program tailored to their needs. Pupils have opportunities to learn, understand, and experience independence focusing on assisted travel training, community awareness, cooking, shopping, cleaning, laundry, personal hygiene, and personal care.

Pupils also work on their personal and social development which will assist in developing qualities of self-esteem, respect, and care for others, positive attitudes, a commitment to learning for life, a sense of belonging to society, and confidence in coping with life in a changing world. Supporting children and young people with Functional Skills helps to develop communication, team working, presentation, and problem solving. They are a key to success and they open doors to learning, to life, and towards independence.

The programme also aims to continue with a range of vocational experiences to support work and social skills.



Contact Us

01829 741 869

Telephone:

iMap School

Address:

Unit 4a

Barrowmore Estate

Barhouse Lane Great

Barrow

CH3 7JA

Website: www.barrowmore.imapcentre.co.uk

Email: schoolenquiries@imapcentre.co.uk

Principal: Andrea.Nelson@iMapcentre.co.uk

Proprietor: Martin.McKevitt@iMapcentre.co.uk



Understand



Empower



Aspire

"I am passionate about providing the very best opportunities for the young people at iMap so that they can thrive within an educational setting."

-Christine Merrick
Principal of iMap School



University of
Chester



ASDAN
Registered Centre